

Measuring guide

HØLTE



MEASURING GUIDE

We set out to provide an accessible kitchen system that gives our customers a bespoke kitchen without the burden of a bespoke price tag. In order to make this possible, we do require a little more input from our customers than fully-bespoke services.

Our products are manufactured using measurements provided to us by you. This step-by-step process will help you put together your measurement package to send to us so we can get to work designing your dream kitchen.

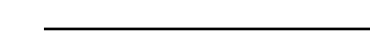

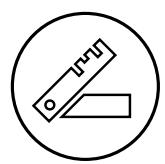

Please take extra care when taking your measurements. We will use these for all of our production drawings, we strongly recommend a professional measuring service for your own peace of mind.

01

Start with your general floor plan

Decide a starting point and work around the room marking the layout.

Be sure to include anything that takes up space such as radiators, boilers, piping, door frames and skirting.

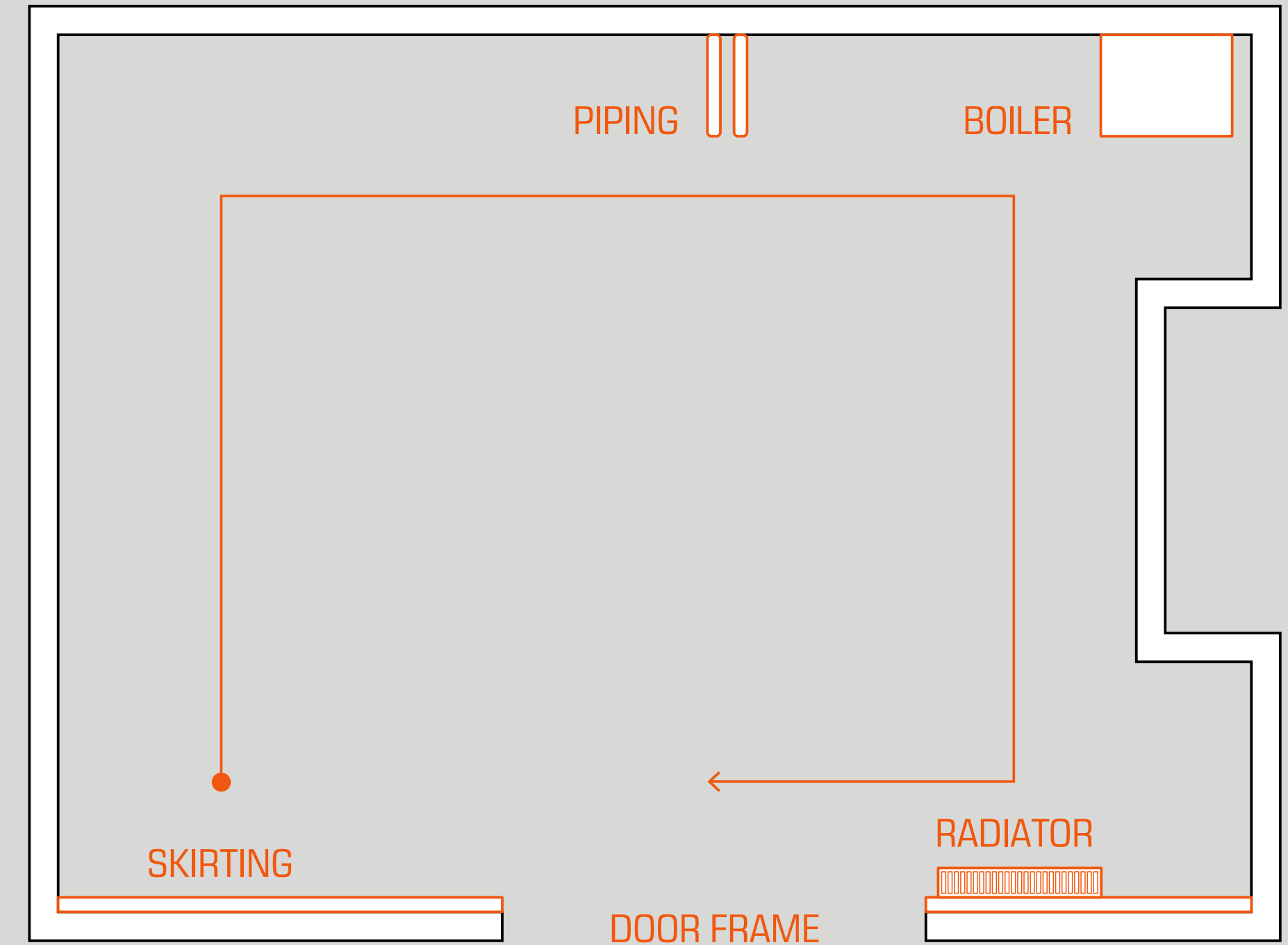

02

Mark the position of your doors and windows, with the direction in which they open

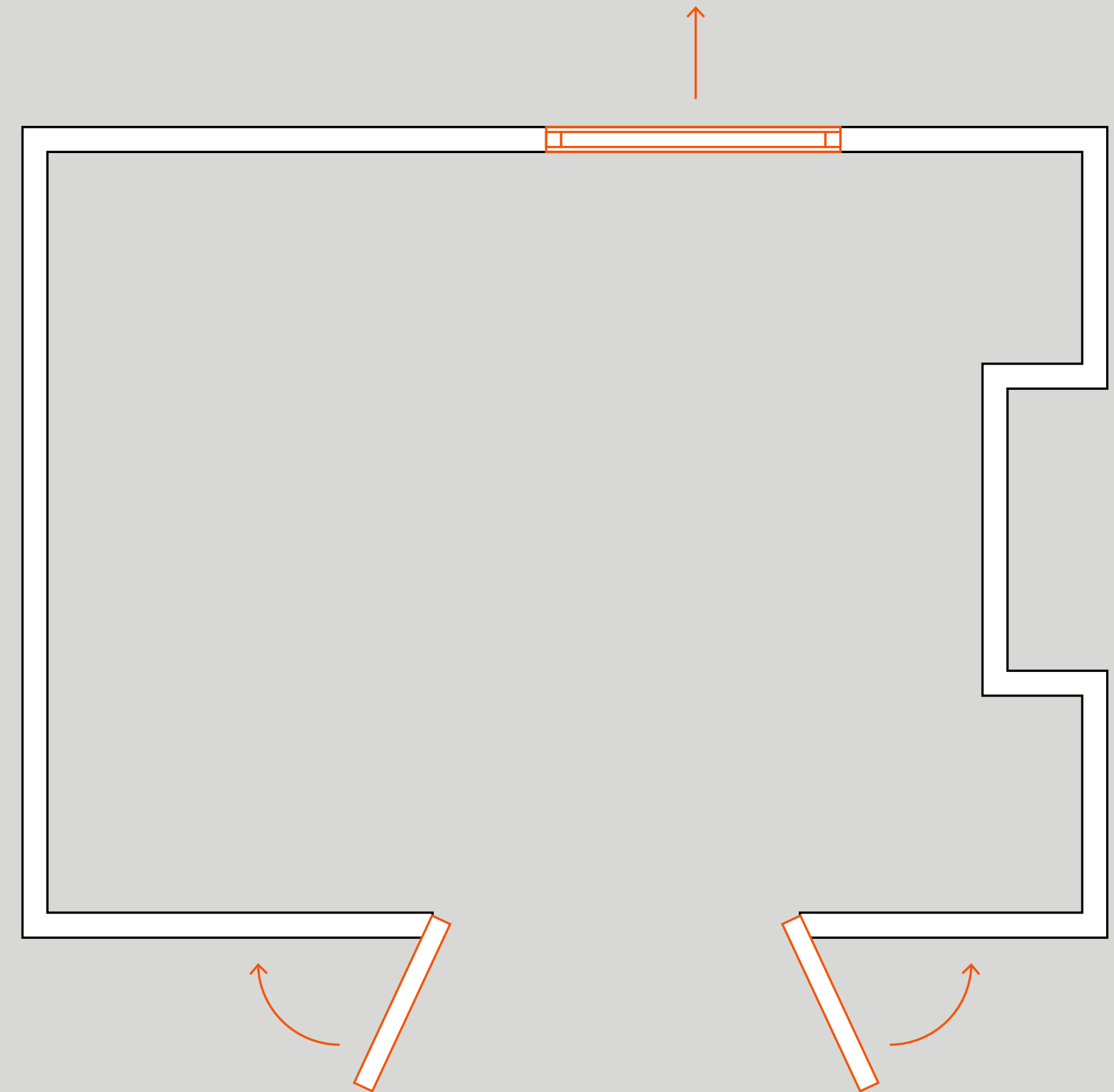

03

Add accurate measurements to your drawing

Include the distance from doors and windows to the corners of the room. Measure from the outer edge of the door frame/window reveals to the wall.

If any corners are particularly obscure, please note on the drawing.

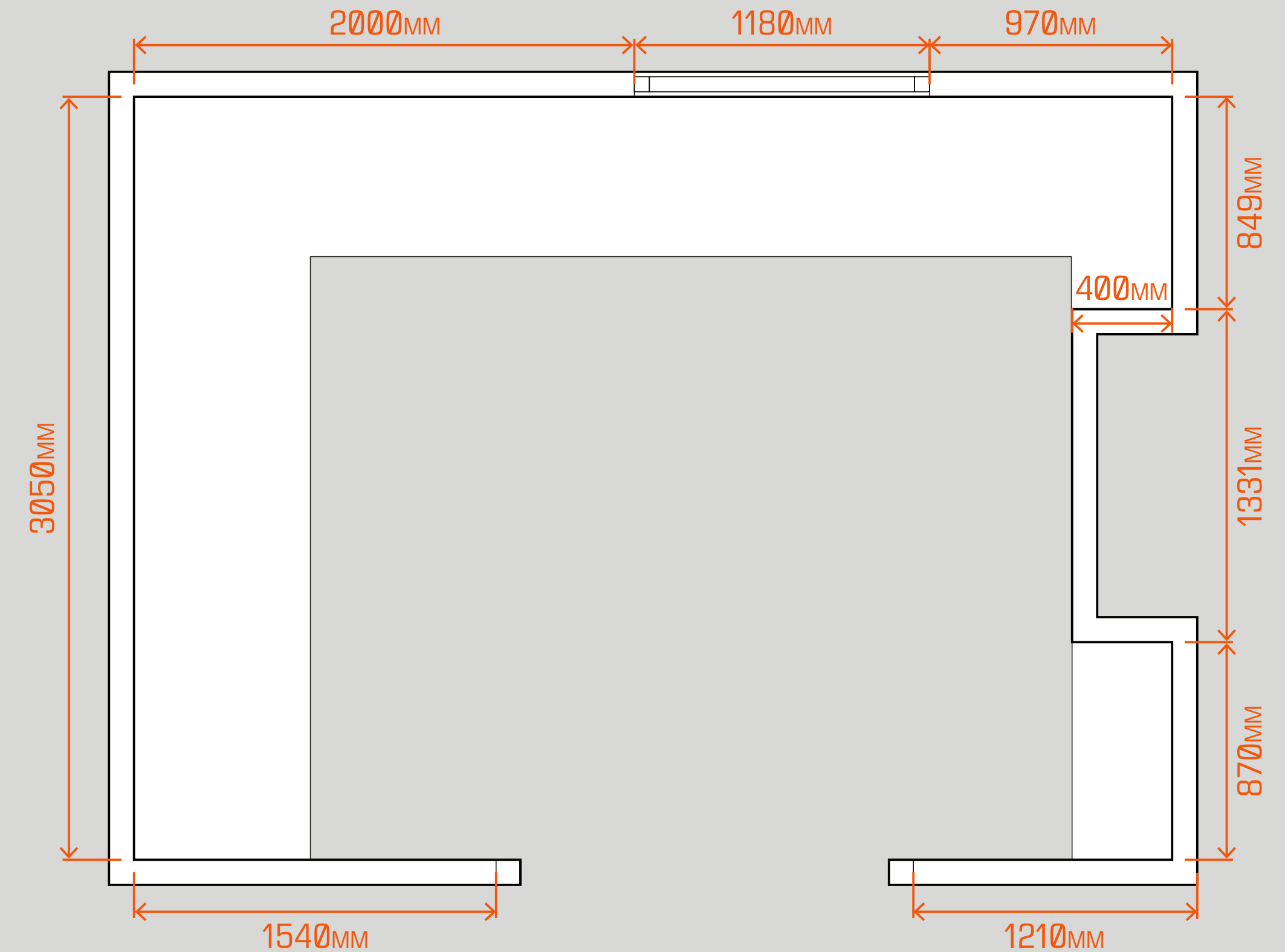

04

Go back over your floor plan and mark the final positions of the services – water, gas, electricity, and ventilation

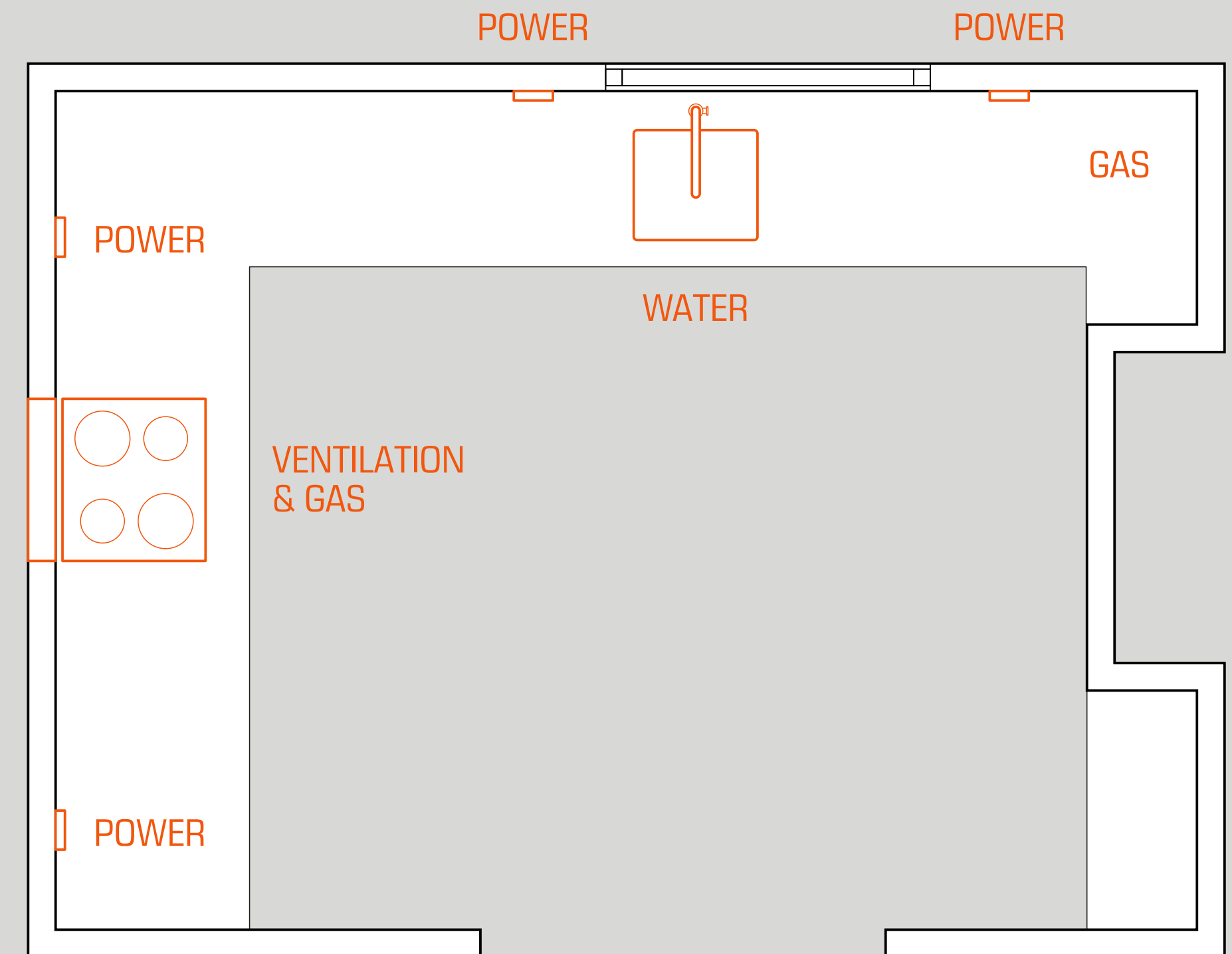

05

Now to move on
to the elevations

Go round each wall (and any island
to be included) and sketch each one,
including all features, e.g. vents,
radiators, power sockets, boilers.

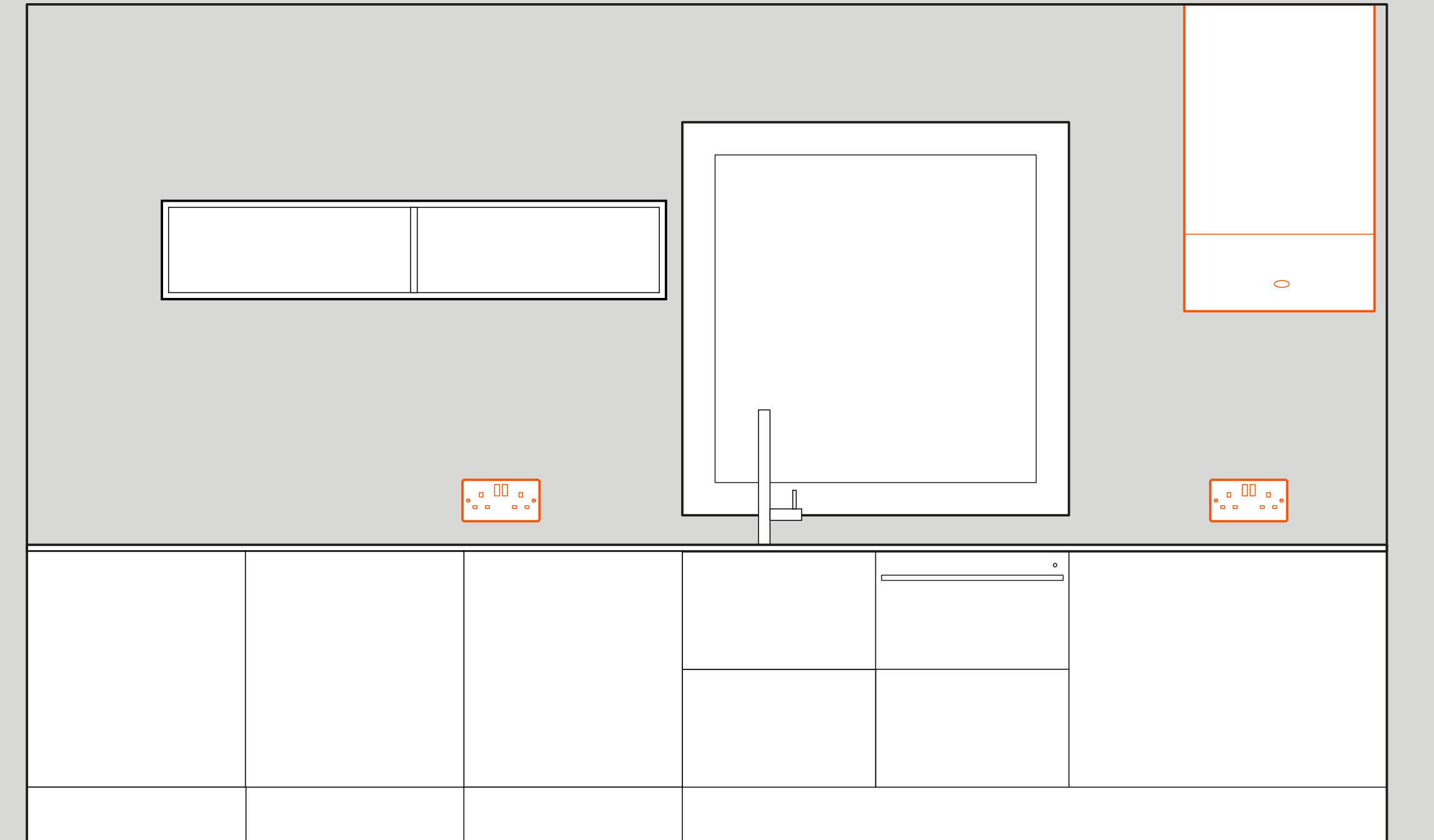

06

Add measurements to your elevations, including heights from floor to ceiling

Also include the distance from windows and doors to the ceiling and floor.

It is important to take a few measurements for these heights across the room, as floors may be uneven.

MEASURING GUIDE

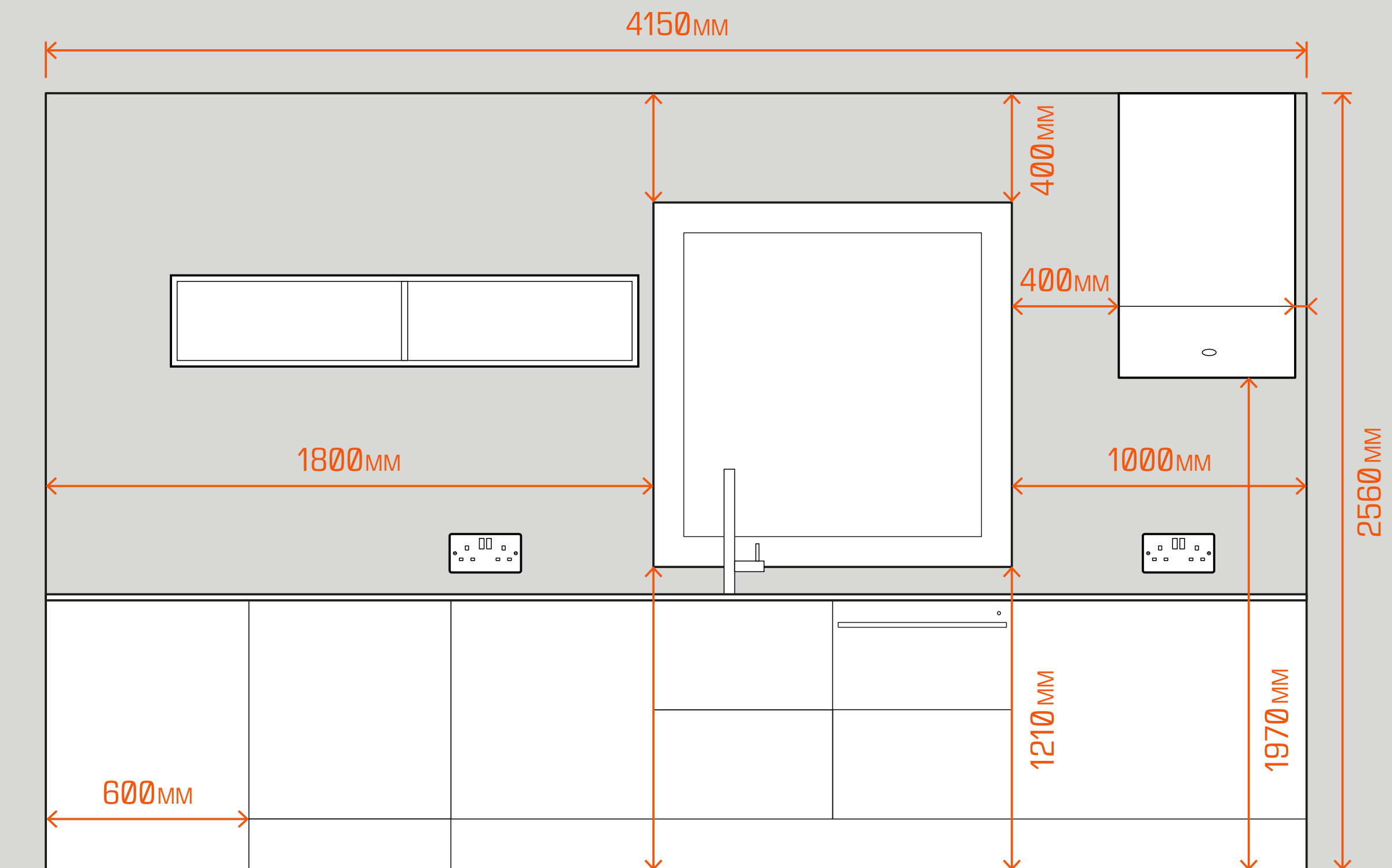

07

Double-check
your measurements

MEASURING GUIDE

01

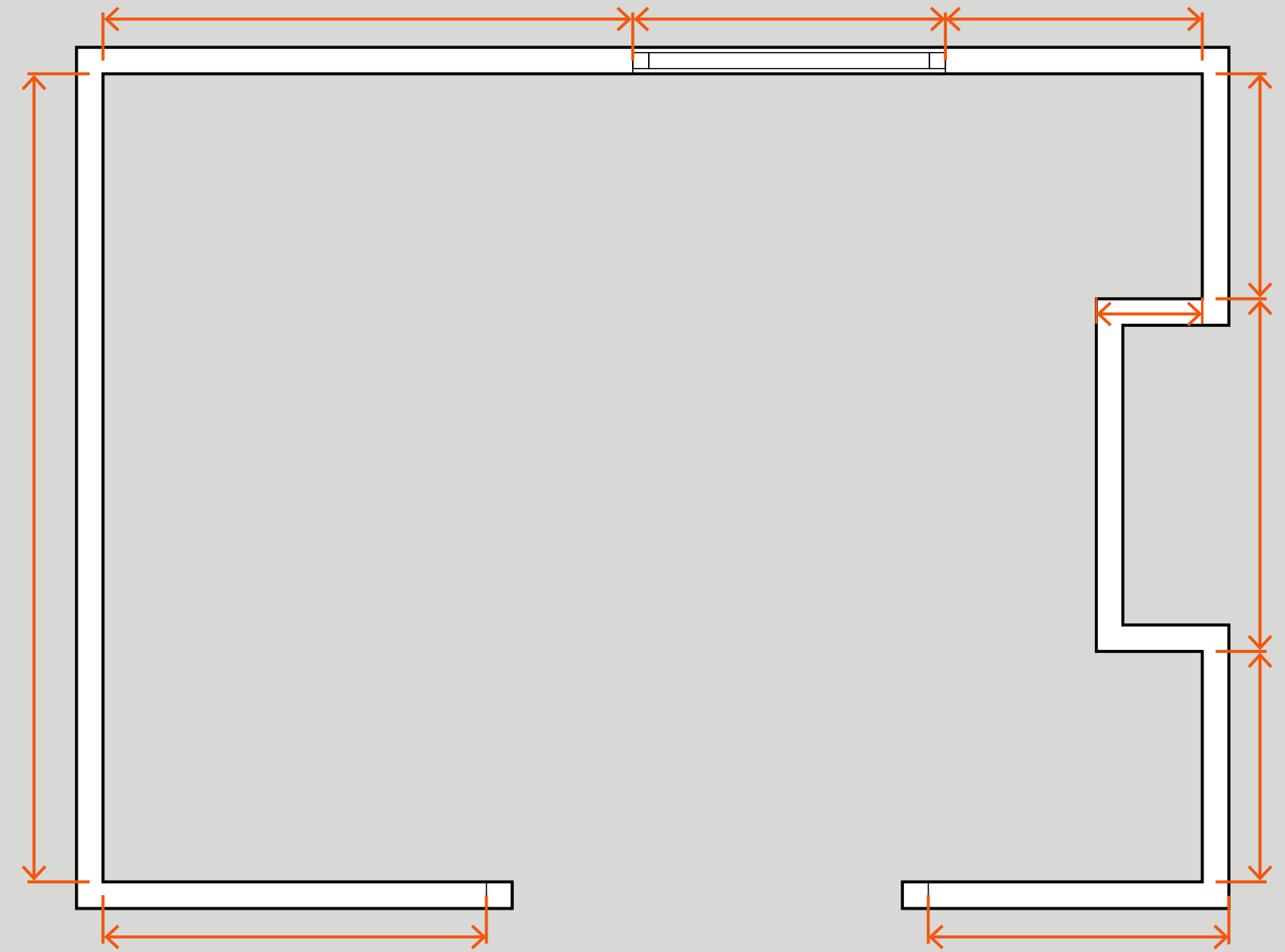

02

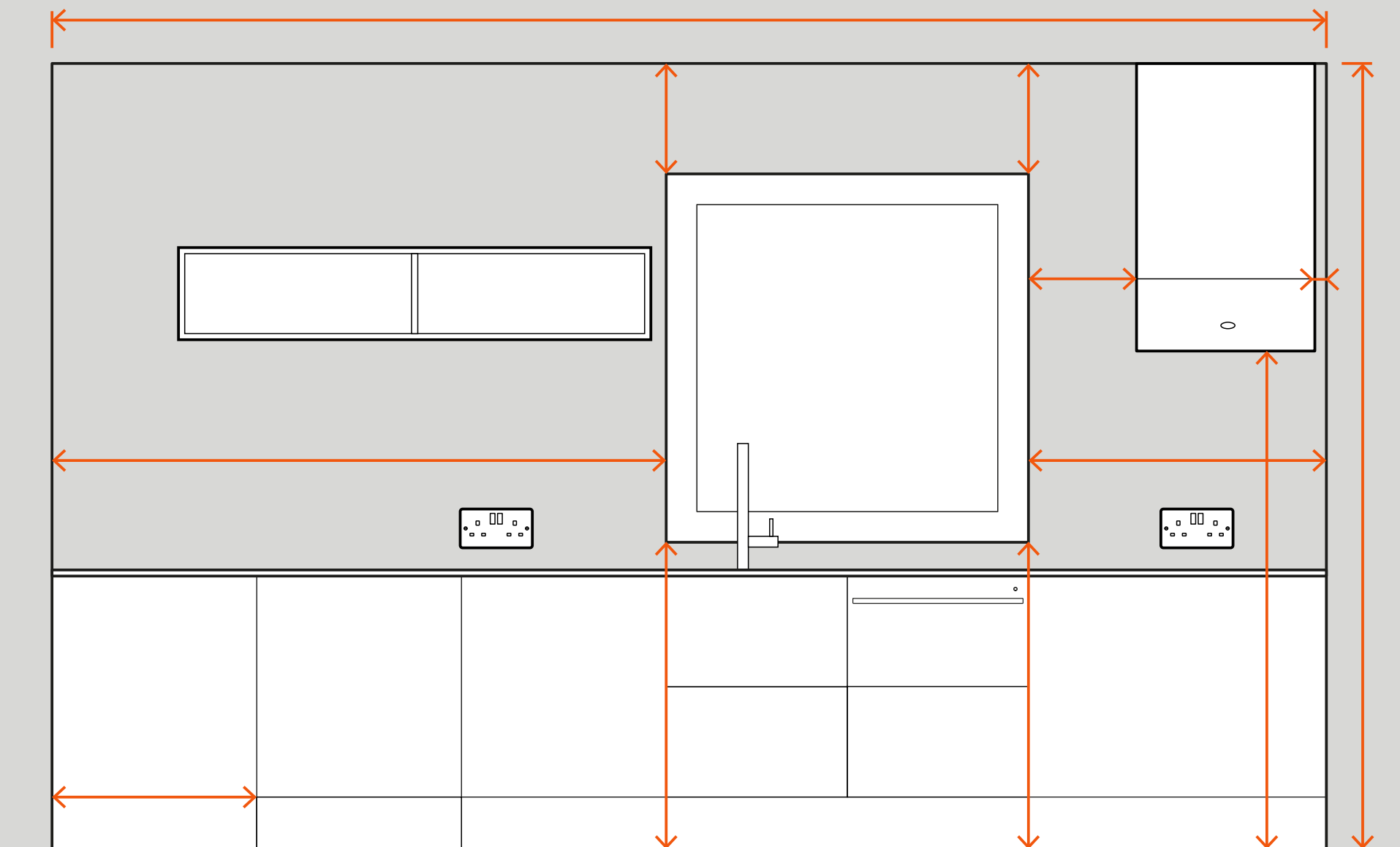

STUDIO
07960 976 895
0207 041 6015

hello@holte.studio

Unit G05 Northside Studios
16-29 Andrews Road
London E8 4QF

Monday to Friday 9am-6pm
Saturday 10am-5pm

holte.studio

HØLTE